

HX 400/300 300L/200L



HX400, HX300, HX300L, HX200L

Manipulator Specifications

Item		Specification				
Model		HX400	HX300	HX300L	HX200L	
Payload		400Kg	300Kg	300Kg	200Kg	
Mechanical Structure		Articulated				
Max. Reach		2,573mm		3,056mm		
Degree of freedom		6				
Installation		Floor				
Max. Working Envelope	Arm	S Swivel	±180°			
		H For/Backward	±75°			
		V Up/Downward	+30° ~ -125°			
	Wrist	R2 Rotation 2	±360°			
		B Bending	±120°			
R1 Rotation 1		±360°				
Max. Speed	Arm	S Swivel	95°/s	90°/s	95°/s	
		H For/Backward	95°/s	90°/s	95°/s	
		V Up/Downward	95°/s	85°/s	95°/s	
	Wrist	R2 Rotation 2	100°/s	110°/s	110°/s	120°/s
		B Bending	100°/s	110°/s	110°/s	120°/s
R1 Rotation 1		160°/s	180°/s	155°/s	180°/s	
Wrist Torque	R2 Rotation 2	200Kgf·m	170Kgf·m	170Kgf·m	131.5Kgf·m	
	B Bending	200Kgf·m	170Kgf·m	170Kgf·m	131.5Kgf·m	
	R1 Rotation 1	84Kgf·m	70Kgf·m	70Kgf·m	61.6Kgf·m	
Accuracy of position repeatability		±0.3mm				
Ambient Temperature		0 ~ 45°C (273~318K)				
Relative Humidity		20 ~ 85%RH				
Robot's Weight		2,620Kg	2,435Kg	2,685Kg	2,265Kg	
Working Envelope Section Area		4.50m ²	6.10m ²	6.18m ²		

Working Envelope

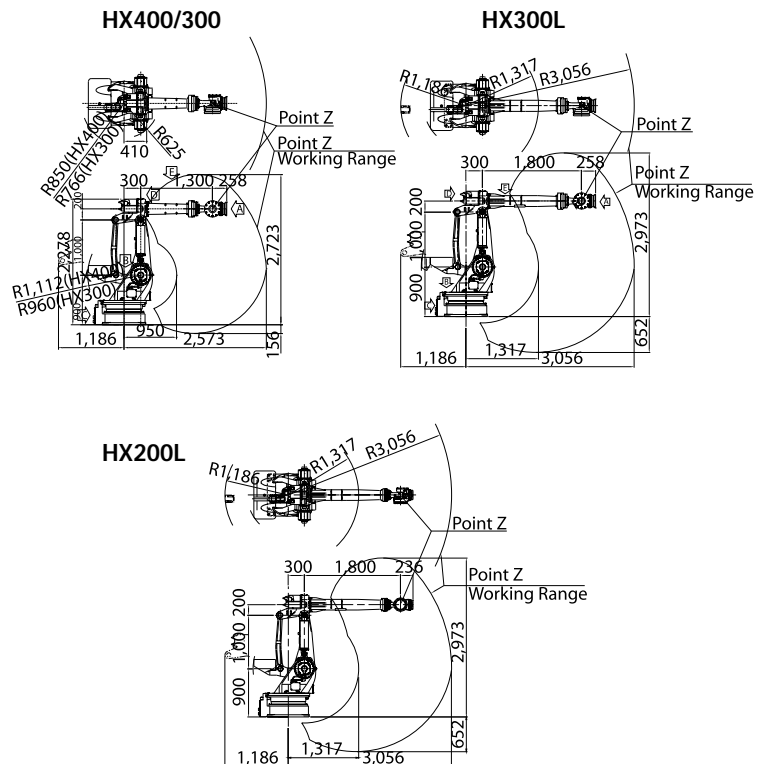

View "A" For Tool Attachment - HX400/300/300L

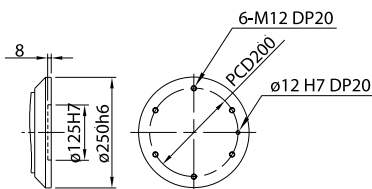

View "A" For Tool Attachment - HX200L

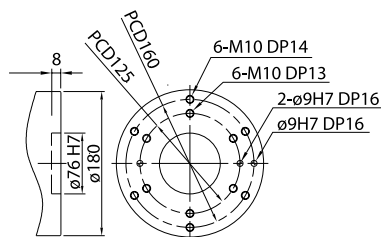

View "B" For Installation

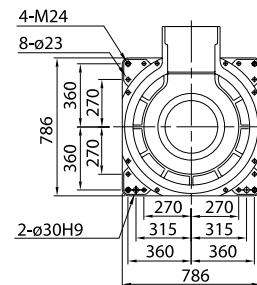

View "C" For User Application

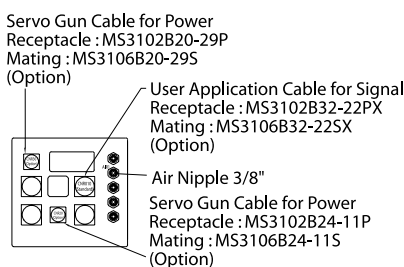

View "D" For User Application (Option)

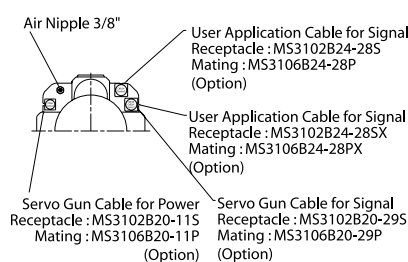

View "E" For Cable Guide

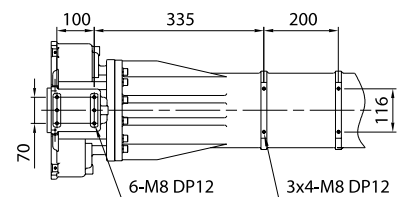

■ Controller Specifications

Item	Specification
Type	Hi4a
Microprocessor Technology	32 bits RISC CPU
Program Execution Mode	Teaching & Playback
Operation Mode	Menu-Driven & Code input
Interpolation Type	Linear, Circular
Memory Back-up Type	Battery back-up IC memory
Encoder Type	Absolute encoder
Servo Drive Unit	6 Axes/unit, digital servo
Maximum Axes	12 Axes Max. Simultaneously
Step	10,000 Points
Program Selection	255(Binary)/8(Discrete)
Teach Pendant Display Spec.	LCD(40X15), Backlight 57,600 baud rates, 3 Position Enable Switch
Digital I/O	Input : 32 points (160 points Max.) Output : 32 points (160Points Max.)
Analog I/O	Input : 4 Points (Option) Output : 4 Points (Option)
Conveyor Pulse Counter	Line Driver / Voltage Output (Option)
Serial Port	RS232C : 2 Ports (1Port : Option)
Communication Function (Option)	DeviceNet, Profibus-DP, Ethernet, CC-Link
PC Card Function	PCMCIA (IC card : Option)
Rated (Supply) Voltage	3-phase 220V (50/60Hz)±10%
Max. Rated Power	8KVA
Dimension (WxHxD)	675mm x 1,190mm x 675mm
Weight (Without Transformer)	205Kg
Protection Classification	IP54
Ambient Temperature	0~45°C
Ambient Humidity	Normal 75%

- Easy and Simple Operation
- Powerful Robot Language
- Easy Maintenance
 - Displaying cause of errors and troubleshooting
- Safety
- Compatibility and Connectivity
 - Embedded PLC
 - FieldBus : DeviceNet, Profibus-DP, CC-link
 - Easy I/O board expansion :
Connecting I/O master through Computer
- Compact Size Controller
 - Default space for 2 additional axis amp

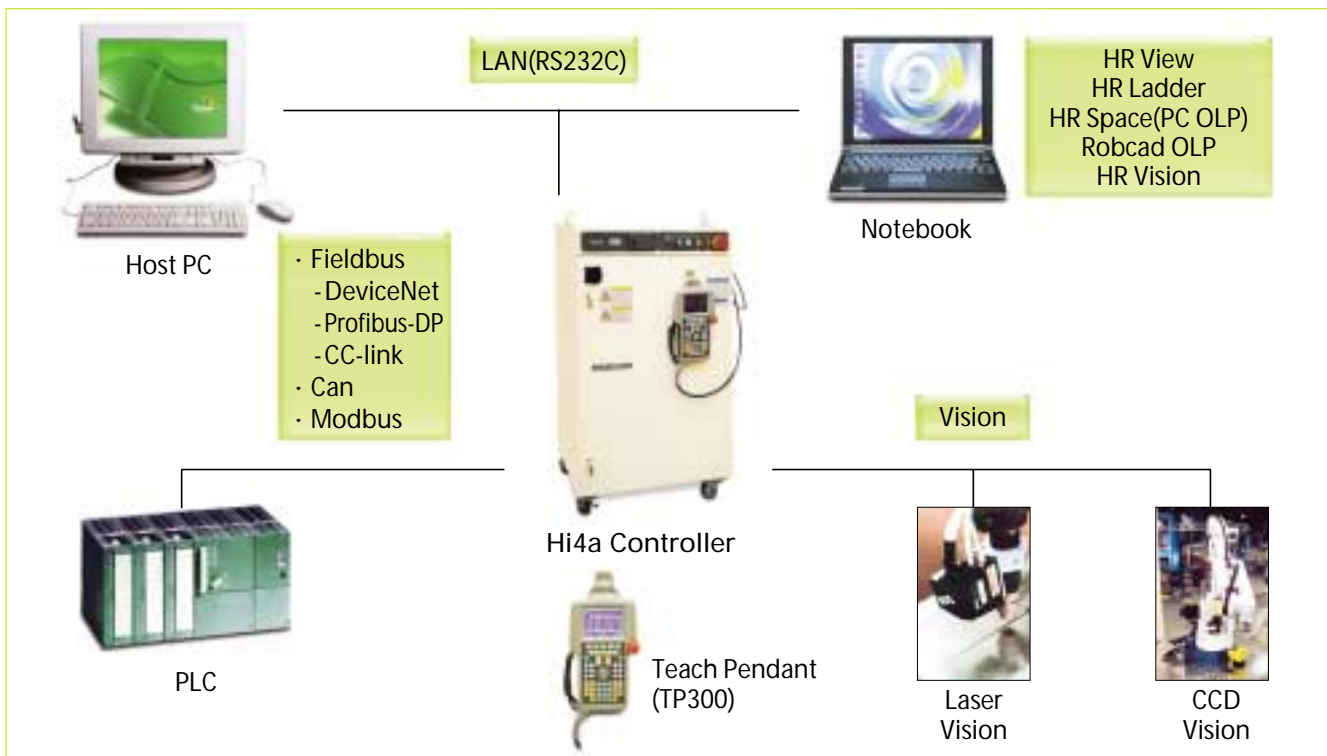



Key Features

Optimal control of noise & vibration,
high loading capacity!

- Adapting RV reducer for all axes
- Internally equipped application cables
- New structure for swing axes
- Various application by modular concept



Application

- Spot welding
- Material handling
- Machine loading and unloading



■ Certificate (UL, CSA, CE, ISO, QS) ■



Head Office

1, Jeonha-dong, Dong-gu, Ulsan, Korea
TEL : 82-52-230-7901 / FAX : 82-52-230-7900

Seoul Office

140-2, Gye-dong, Jongno-gu, Seoul, Korea
TEL : 82-2-746-4711 / FAX : 82-2-746-4720

Ansan Office

1431-2, Sa-dong, Sangnok-gu, Ansan-si,
Gyeonggi-do, Korea
TEL : 82-31-409-4945 / FAX : 82-31-409-4946

Cheonan Office

355-15, Daga-dong, Cheonan-si,
Chungcheongnam-do, Korea
TEL : 82-41-576-4294 / FAX : 82-41-576-4296

Daegu Office

223-5, Beomeo 2-dong, Suseong-gu, Daegu, Korea
TEL : 82-53-746-6232 / FAX : 82-53-746-6231

Gwangju Office

415-2, Nongseong-dong, Seo-gu, Gwangju, Korea
TEL : 82-62-363-5272 / FAX : 82-62-363-5273